



KG1 SERIES BULKHEAD FITTING GLAND

- *High levels of EMC performance*
- *Proven IRIS spring technology for overall screening*
- *Heavy-duty brass construction - ideal for industrial and commercial use*
- *Environmental sealing up to IP 66/67 with integral 'O' ring seals*

The **KG1** series is part of the **KG** range of high performance, bulkhead glands. A variety of techniques are used in the range to provide electromagnetic compatibility, including TEMPEST level performance, for both individual and overall screening and environmental protection.

Suitable for both highly sophisticated and simpler solutions, the KG range is available at prices that are viable for small batch to high volume production runs. The range is ideal for all defence and aerospace as well as commercial and industrial applications.

KEC Limited is an EMC interconnect specialist that manufactures a wide selection of backshells, bulkhead/panel glands, conduit and conduit fittings and system harnesses.

KEC products are designed to suit all levels of screening requirements for EMI/RFI, EMP, TEMPEST and environmental protection and are designed to help manufacturers comply with UK and EC screening directives.

KG1 BULKHEAD GLAND

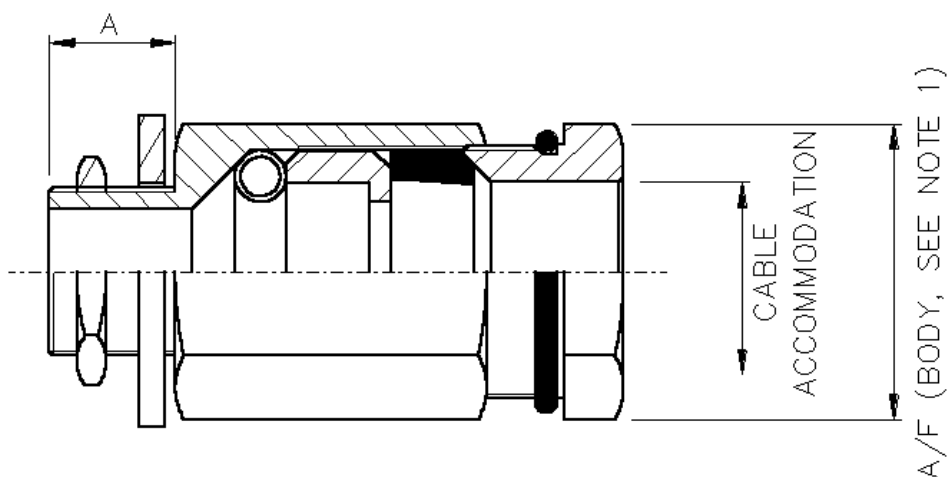

TYPICAL PART NUMBER KG105-25*-XXX

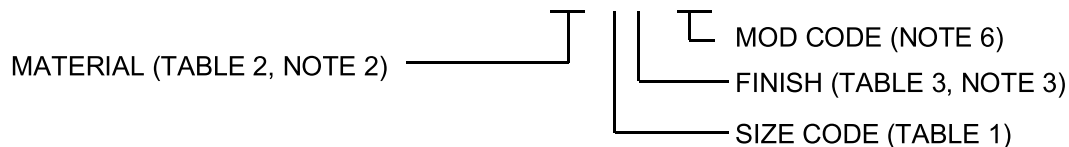

TABLE 1

SIZE CODE	A	A/F (BODY)	CABLE ACCOMMODATION				MAX LENGTH
			CABLE DIAMETER		ARMOUR DIAMETER		
			MIN	MAX	MIN	MAX	
M10	12.0	15.88	1.8	4.4	1.5	4.3	32.0
M12	12.0	20.64	4.0	7.6	3.7	7.5	32.0
M12A	12.0	20.64	6.0	9.0	5.7	8.9	32.0
M16	15.0	27.0	8.6	13.2	5.0	10.4	52.0
M20	15.0	33.0	15.5	20.8	13.9	16.4	52.0
M25	15.0	42.4	22.0	27.2	19.9	23.1	52.0
M32	15.0	47.24	28.3	33.5	26.2	28.0	60.0
M40	20.0	57.15	34.7	39.9	32.1	36.1	60.0

TABLE 2

MATERIAL CODE	
01	ALUMINIUM
02	STAINLESS STEEL
05	BRASS

TABLE 3

FINISH CODE	
G	BLACK ZINC NICKEL
J	ELECTROLESS NICKEL
W	CADMIUM + OLIVE DRAB
Z	ZINC COBALT + OLIVE DRAB

NOTES:

1. ACROSS CORNERS DIAMETER IN ACCORDANCE WITH BS6121.
2. STANDARD MATERIAL FINISH IS BRASS, SELF FINISH. OTHER MATERIALS AND FINISHES AVAILABLE. SEE TABLE 2 FOR MATERIAL & TABLE 3 FOR FINISH.
3. OMIT FINISH CODE IF NOT REQUIRED.
4. MINIMUM PANEL THICKNESS 1.5mm.
5. THE ABOVE INFORMATION IS TYPICAL AND MANY OTHER OPTIONS & VARIATIONS ARE AVAILABLE, PLEASE CONSULT FACTORY.
6. CONSULT FACTORY IF REQUIRED.

04/20

KEC LIMITED

Orpheus House, Calleva Park, Aldermaston, Reading, Berkshire RG7 8TA England
Tel: +44 (0)118 981 1571 Fax: +44 (0)118 981 1570 email: sales@kec.co.uk www.kec.co.uk